

# T Level Technical Qualification in Digital Support Services

Occupational specialism assessment (OSA)

## Digital Infrastructure

Assignment 3

Workbook

v1.1: Additional sample material  
17 November 2023  
603/6901/2

## T Level Technical Qualification in Digital Support Services Occupational specialism assessment (OSA)

# Digital Infrastructure

## Workbook

### Assignment 3

## Contents

<b>About this assignment</b> .....	<b>3</b>
Introduction .....	3
Evidence .....	3
<b>Task 1: risk assessment template</b> .....	<b>4</b>
<b>Task 1: office floor plan</b> .....	<b>5</b>
<b>Task 2</b> .....	<b>6</b>
<b>Task 3</b> .....	<b>7</b>
<b>Task 4</b> .....	<b>8</b>
Browser history .....	8
<b>Review and submit</b> .....	<b>9</b>
<b>Document information</b> .....	<b>10</b>
Change History Record .....	10

## About this assignment

### Introduction

All evidence should be placed in this workbook.

Save your document regularly as you work through the assignment. It is recommended you save after inserting each piece of evidence.

Submit this workbook in .pdf format at the end of the assignment using the file naming convention below.

Surname\_Initial\_student number\_Workbook3

For example, Smith\_J\_123456789\_Workbook3.pdf

### Evidence

All screenshots should be numbered and linked to the task.

For example, task 1, evidence 2 would be shortened to 1.2.

Ensure each screenshot is labelled with a brief description of what is being shown.

SAMPLE

## Task 1: risk assessment template

Threat	Vulnerability	Asset	Impact	Likelihood	Risk	Action	Control type
Such as passwords cracked by attacker.	Lack of password complexity policy.	Files or data on file shares. High.	Critical data could be accessed by a malicious attacker and stolen. Critical.	Attackers would need access to the network or password hash to attempt this. Medium.	Data is exfiltrated from the company with potential to damage company reputation, breach of GDPR with financial implications and potential for customers becoming victims of identity theft. High.	Implement complex password policy in directory services.	Technical/ preventative.

<b>Risk levels:</b> low   medium   high   critical	<b>Business control types:</b> physical   administrative   technical	<b>Mitigating control types:</b> preventative   detective   corrective   deterrent   directive   compensating   acceptance
---	---	---

## Task 1: office floor plan

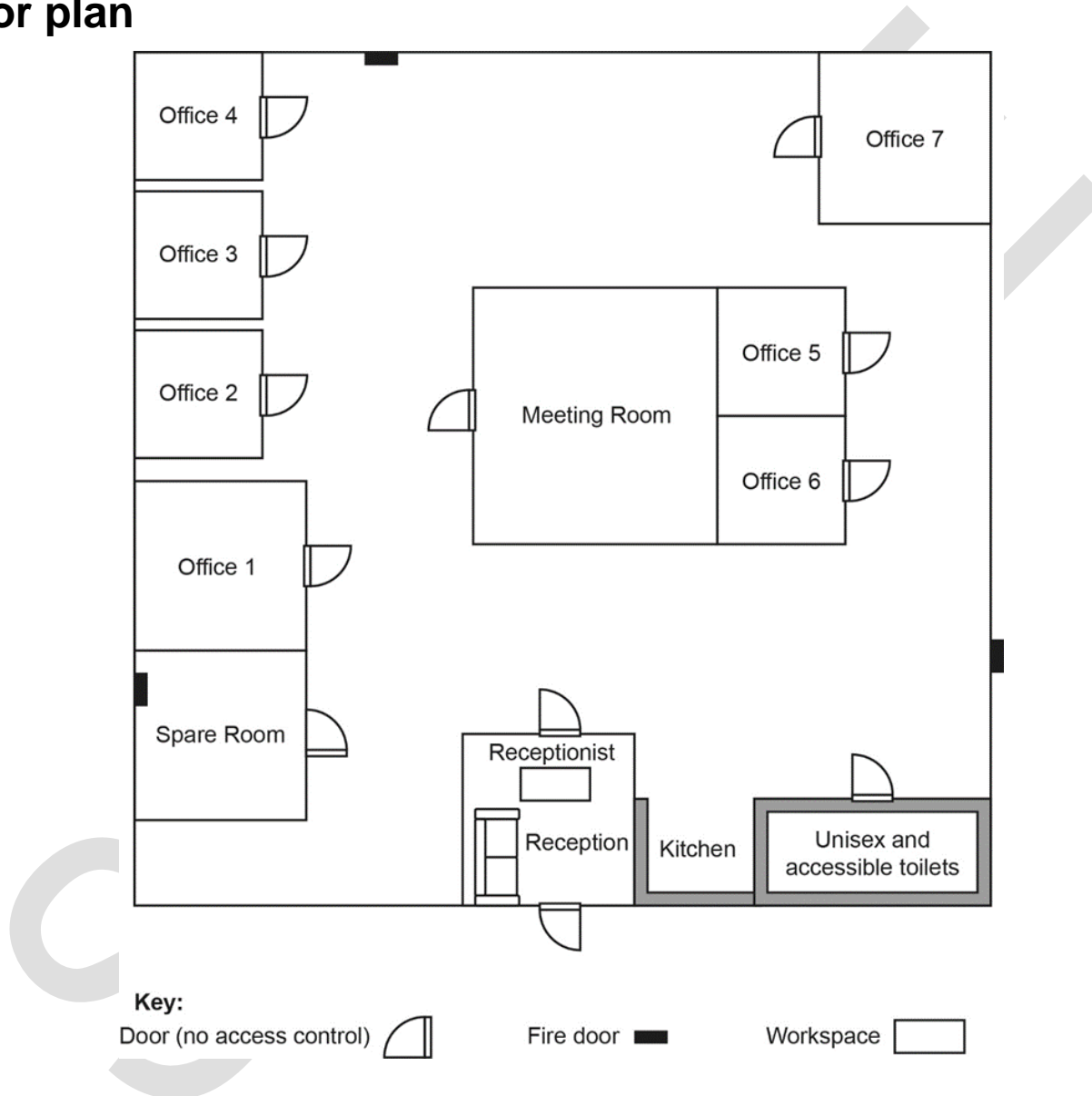

## Task 2

### Security policy presentation

SAMPLE

## **Task 3**

**Business continuity recommendations document**

**Disaster recovery recommendations document**

SAMPLE

## Task 4

Please duplicate 'action 1' for each additional action you have taken to harden the system

### Action 1

<b>Description of action you have chosen to implement</b>
<b>Screenshots of server and/or client settings before the configuration change, during the change and after the change (the reconfigured system)</b>
<b>Any unexpected results found whilst hardening the system</b>
<b>Explain how the action you have taken will better protect the system</b>
<b>Websites accessed</b>

### Browser history

Please insert a screenshot of your browser history here.



## Review and submit

You have now reached the end of the assignment. It is recommended that you review all the evidence required for the assignment to ensure all screenshots and annotations have been provided.

Save this document and convert into a .pdf for submission using the file naming convention below.

Surname\_Initial\_student number\_Workbook3

For example, Smith\_J\_123456789\_Workbook3.pdf

SAMPLE

## Document information

Copyright in this document belongs to, and is used under licence from, the Institute for Apprenticeships and Technical Education, © 2023.

'T-LEVELS' is a registered trade mark of the Department for Education.

'T Level' is a registered trade mark of the Institute for Apprenticeships and Technical Education.

The T Level Technical Qualification is a qualification approved and managed by the Institute for Apprenticeships and Technical Education. NCFE is currently authorised by the Institute to develop and deliver the T Level Technical Qualification in Digital Support Services.

'Institute for Apprenticeships & Technical Education' and logo are registered trade marks of the Institute for Apprenticeships and Technical Education.

Owner: Head of Assessment Design

## Change History Record

Version	Description of change	Approval	Date of Issue
v1.0	Additional sample material		01 September 2023
v1.1	Sample added as a watermark	November 2023	17 November 2023